

DEPARTMENT LEGEND

- BUILDING SUPPORT
- CENTRAL HOLDING
- JUDGE'S CHAMBERS
- SECURED PARKING
- VEHICULAR SALLYPORT

SQUARE FOOTAGE:

| | |
|----------------|-------------------|
| Level 00 : | 24,365 SF |
| Level 01 : | 37,818 SF |
| Level 02 : | 36,936 SF |
| Level 03 : | 36,943 SF |
| Level 04 : | 36,943 SF |
| Total : | 173,005 SF |

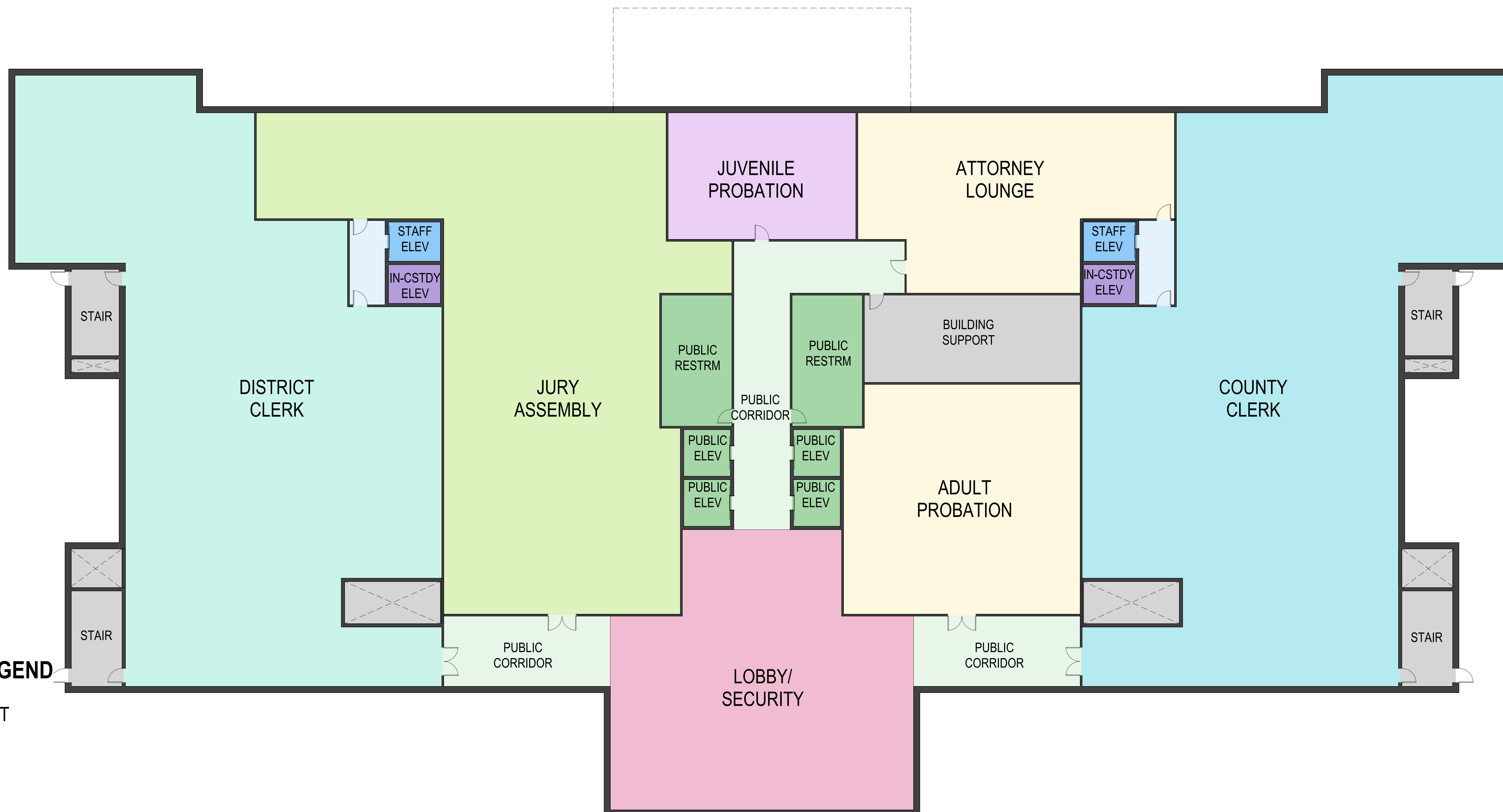

DEPARTMENT LEGEND

- BUILDING SUPPORT
- COUNTY CLERK
- COURT HOLDING
- COURT SUPPORT
- DISTRICT CLERK
- JUDGE'S CHAMBERS
- JURY ASSEMBLY
- JUVENILE PROBATION
- LOBBY/SECURITY
- PRIVATE CORRIDOR
- PUBLIC
- PUBLIC CORRIDOR

SQUARE FOOTAGE:

Level 00 : 24,365 SF
Level 01 : 37,818 SF
Level 02 : 36,936 SF
Level 03 : 36,943 SF
Level 04 : 36,943 SF

Total : 173,005 SF

LEVEL 01 - FLOOR PLAN

PARKER COUNTY JUSTICE CENTER



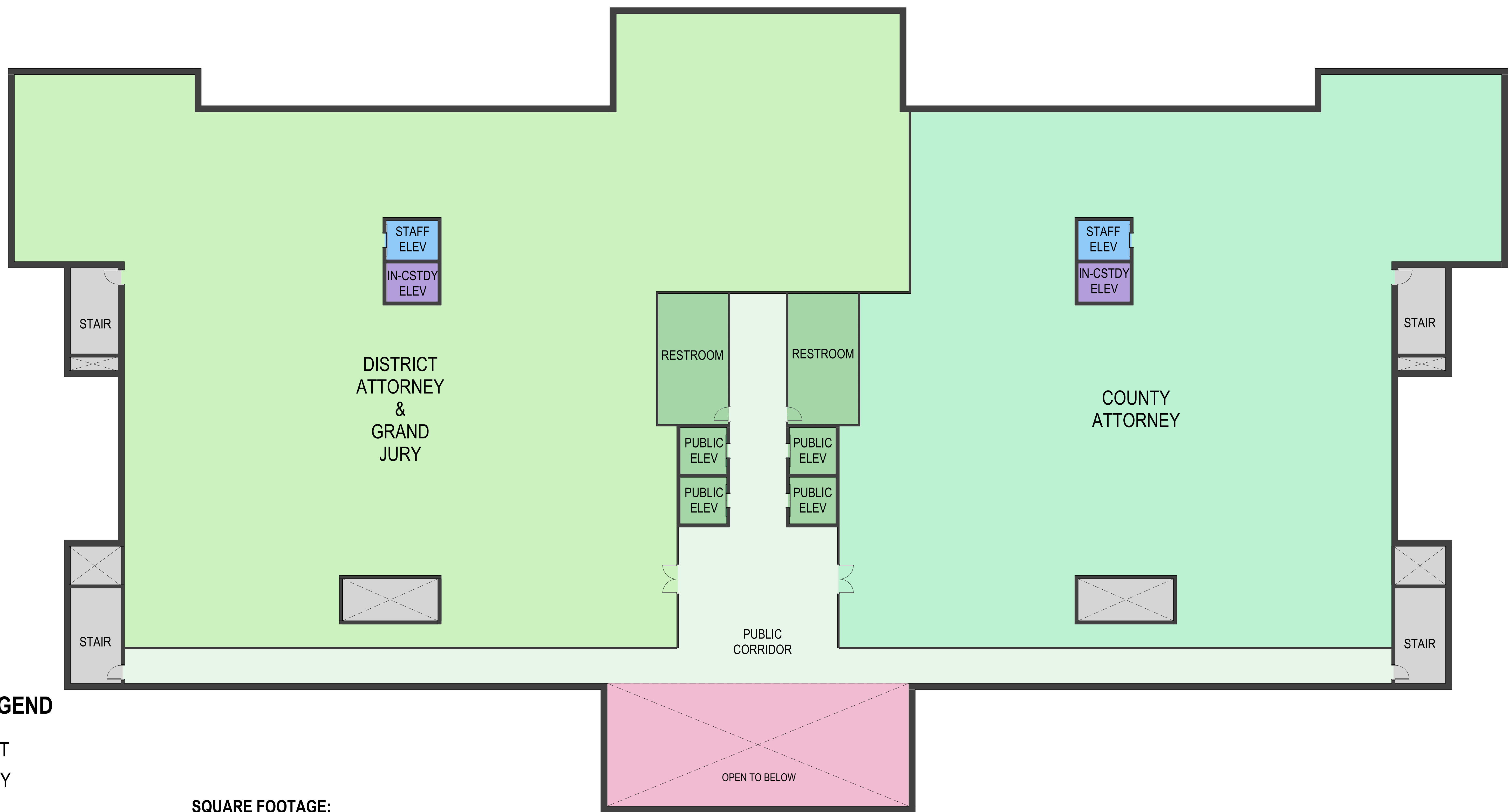

DEPARTMENT LEGEND

- BUILDING SUPPORT
- COUNTY ATTORNEY
- COURT HOLDING
- DISTRICT ATTORNEY / GRAND JURY
- JUDGE'S CHAMBERS
- LOBBY/SECURITY
- PUBLIC
- PUBLIC CORRIDOR

SQUARE FOOTAGE:

| | |
|-------------------|-------------------|
| Level 00 : | 24,365 SF |
| Level 01 : | 37,818 SF |
| Level 02 : | 36,936 SF |
| Level 03 : | 36,943 SF |
| Level 04 : | 36,943 SF |
| Total : | 173,005 SF |



DEPARTMENT LEGEND

- BUILDING SUPPORT
- COURT HOLDING
- COURT SUPPORT
- COURTS
- JUDGE'S CHAMBERS
- PRIVATE CORRIDOR
- PUBLIC
- PUBLIC CORRIDOR

SQUARE FOOTAGE:

Level 00 : 24,365 SF
 Level 01 : 37,818 SF
 Level 02 : 36,936 SF
Level 03 : 36,943 SF
 Level 04 : 36,943 SF

Total : 173,005 SF

LEVEL 03 - FLOOR PLAN

PARKER COUNTY JUSTICE CENTER





DEPARTMENT LEGEND

- BUILDING SUPPORT
- COURT HOLDING
- COURT SUPPORT
- COURTS
- JUDGE'S CHAMBERS
- PRIVATE CORRIDOR
- PUBLIC
- PUBLIC CORRIDOR

SQUARE FOOTAGE:

Level 00 : 24,365 SF
 Level 01 : 37,818 SF
 Level 02 : 36,936 SF
 Level 03 : 36,943 SF
Level 04 : 36,943 SF
Total : 173,005 SF

LEVEL 04 - FLOOR PLAN

PARKER COUNTY JUSTICE CENTER

